

Nema 7/9 – Explosion Proof

Customer:

Project:

Architect/Engineer:

Contractor:

Drawing No.:

Date:

Sheet

of

Shop Drawing

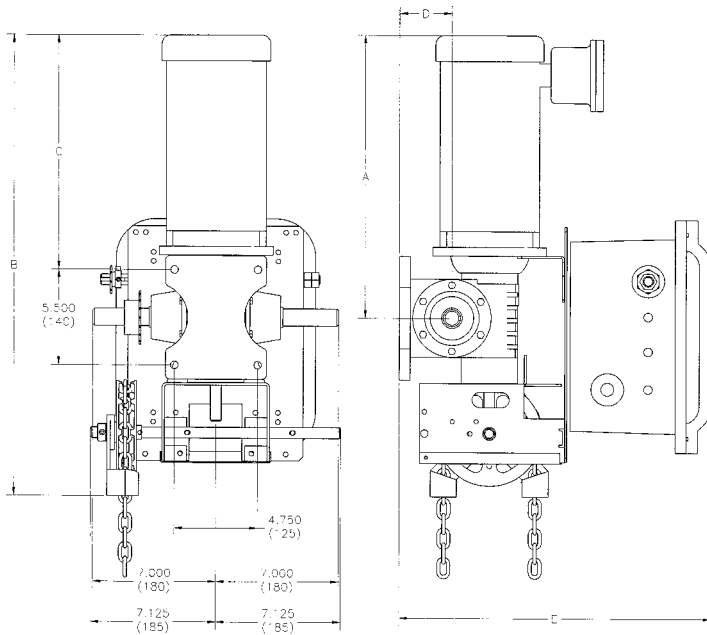

Dimensions	UP TO 1 HP	1.5 TO 2 HP
*A	17.250 (440)	20.125 (512)
*B	27.500 (700)	30.375 (772)
*C	14.500 (370)	17.375 (442)
D	3.000 (80)	3.500 (90)
E	17.875 (455)	19.000 (485)

* Dimensions can vary depending on motor

HP	Motor Amperage Rating				
	Voltage - Phase				
	115 V - 1 Ph	230 V - 1 Ph	208 / 230 V - 3 Ph	460 V - 3 Ph	575 V - 3 Ph
1/2	9.0	4.5	2.2	1.1	-
3/4	11.2	5.6	3.2	1.5	1.2
1	13.6	6.8	3.7	1.7	1.4
1 1/2	19.6	9.8	5.3	2.5	2.0
2	-	-	6.5	3.1	2.5

Specifications For Ordering

Quantity:	Model Number:			
HP:	Amperage:	Volts:	Phase:	Hertz:
Door Type:	Width:	Height:	Lift:	
Hand Chain: (Circle One) Left or Right	Drive Sprocket: (Circle One) Left or Right			
Friction Clutch: (Circle One) Left or Right	Drive Sprocket & Chain: (Circle One) #50 or #60			
Supply	3-Push Button Station(s) in NEMA		Enclosure Per Operator	

Supply Auxiliary and Optional Equipment as specified below: One per operator unless otherwise noted.

**** Note:** The safety control equipment used must be Nema 7/9 or an intrinsically safe control device must be installed, please consult factory. **

Notes:

- Refer to model GH Specification Sheet for General Information
- Refer to Drawing _____ for Wiring Diagram